

AREA STATEMENT

LAND AREA ON WHICH BUILDING TO BE PROPOSED	641.305 SQM.
ADJACENT LAND AREA	44.957 SQM.
AREA OF THE LAND AS PER PARCHA	687.959 SQM.
PHYSICAL MEASUREMENT OF LAND	641.305 SQM.
ROAD WIDTH	AV. 5.1055 M.
PERMISSIBLE GROUND COVERAGE	320.650 SQM. (50%)
PROPOSED GROUND COVERAGE	294.372 SQM. (45.902%)
PROPOSED BUILT-UP AREA	1412.458 sqm.
PERMISSIBLE FAR	1.75
PERMISSIBLE AREA AS PER FAR	1122.284 SQM.
PROPOSED FAR	1.732
PROPOSED AREA AS PER FAR	1110.66 SQM.

CAR PARKING CALCULATION

CAR PARKING CALCULATION (FOR RESIDENTIAL AREA)		CAR PARKING REQUIRED (FOR RESIDENTIAL AREA)	
FLOOR	AREA	600.00 / 130	5 NOS.
GROUND FLOOR	0.00 SQM.	(1038.698-600.00) / 120	4 NOS.
TYP. FL. (1st,2nd,3rd)	820.962 SQM.		
			9 NOS.
4th. FL.	217.736 SQM.		
TOTAL	1038.698 SQM.		10 NOS.

FLOOR	TOTAL FLOOR PLATE AREA	LIFT WELL	CUTOUPS/ POOL OPEN TO SKY AREA	BUILT UP AREA (PL. AREA WITHOUT LIFT WELLS, CUTOUPS & STAIR WELLS)	DEDUCTION FOR F.A.R. CALCULATION	F.A.R. AREA	F.A.R.	FLOOR	CB AREA PROVIDED	PERMISSIBLE CB AREA (3% OF THE FL. AREA)	
					LIFT LOBBY AREA						
GROUND FLOOR	294.372 sqm.	—	—	294.372 sqm.	3.00 sqm.	13.86 sqm.	205.550 sqm.	71.962 sqm.	GROUND FLOOR	0.00 sqm.	0.00 sqm.
1st. FLOOR	293.501 sqm.	2.55 sqm.	0.437 sqm.	290.514 sqm.	3.00 sqm.	13.86 sqm.	—	273.654 sqm.	1st. FLOOR	8.77 sqm.	8.805 sqm.
2nd. FLOOR	293.501 sqm.	2.55 sqm.	0.437 sqm.	290.514 sqm.	3.00 sqm.	13.86 sqm.	—	273.654 sqm.	2nd. FLOOR	8.77 sqm.	8.805 sqm.
3rd. FLOOR	293.501 sqm.	2.55 sqm.	0.437 sqm.	290.514 sqm.	3.00 sqm.	13.86 sqm.	—	273.654 sqm.	3rd. FLOOR	8.77 sqm.	8.805 sqm.
4th. FLOOR	237.583 sqm.	2.55 sqm.	0.437 sqm.	234.596 sqm.	3.00 sqm.	13.86 sqm.	—	217.736 sqm.	4th. FLOOR	6.88 sqm.	7.127 sqm.
TOTAL	1412.458 sqm.	10.20 sqm.	1.748 sqm.	1400.51 sqm.	15.00 sqm.	69.30 sqm.	205.550 sqm.	1110.66 sqm.	TOTAL	33.19 sqm.	33.542 sqm.

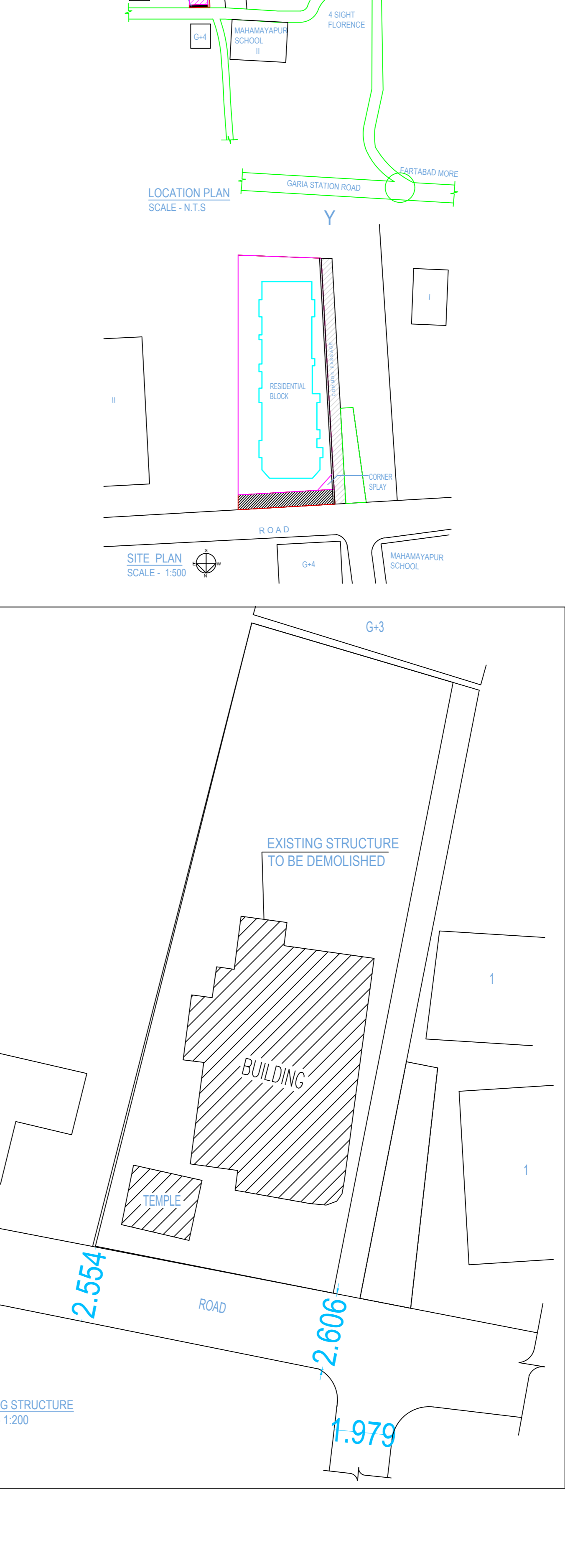
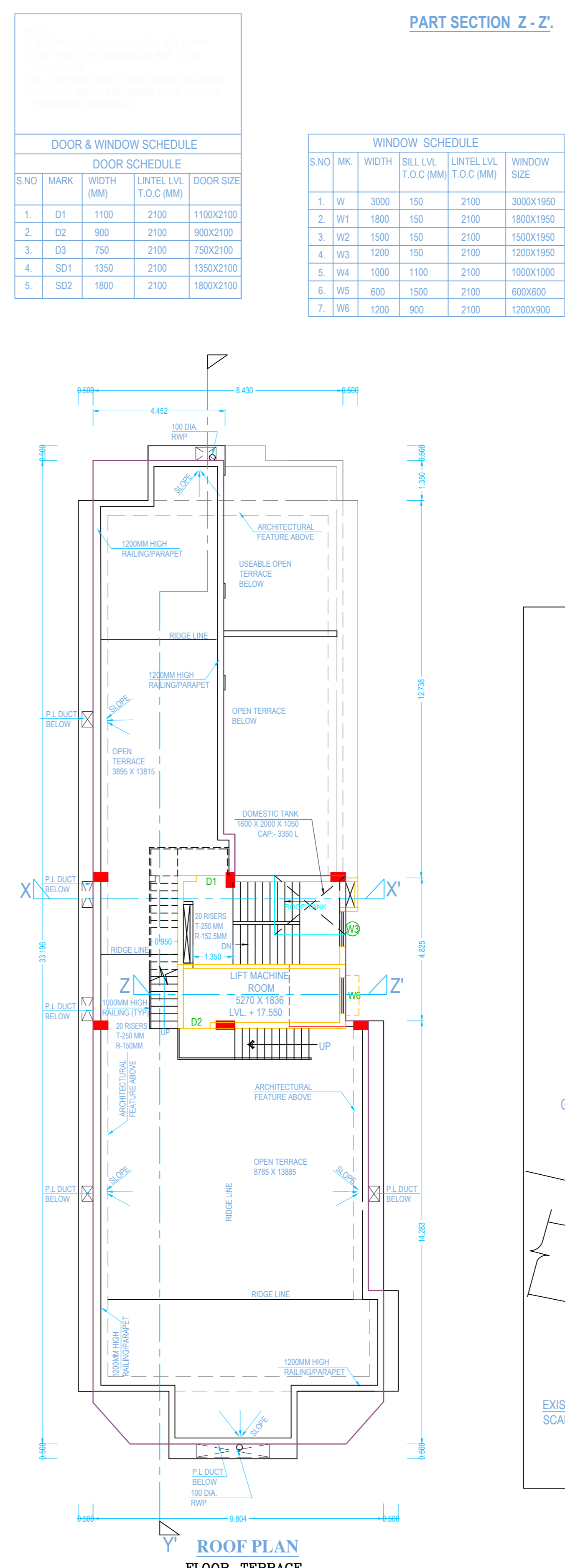
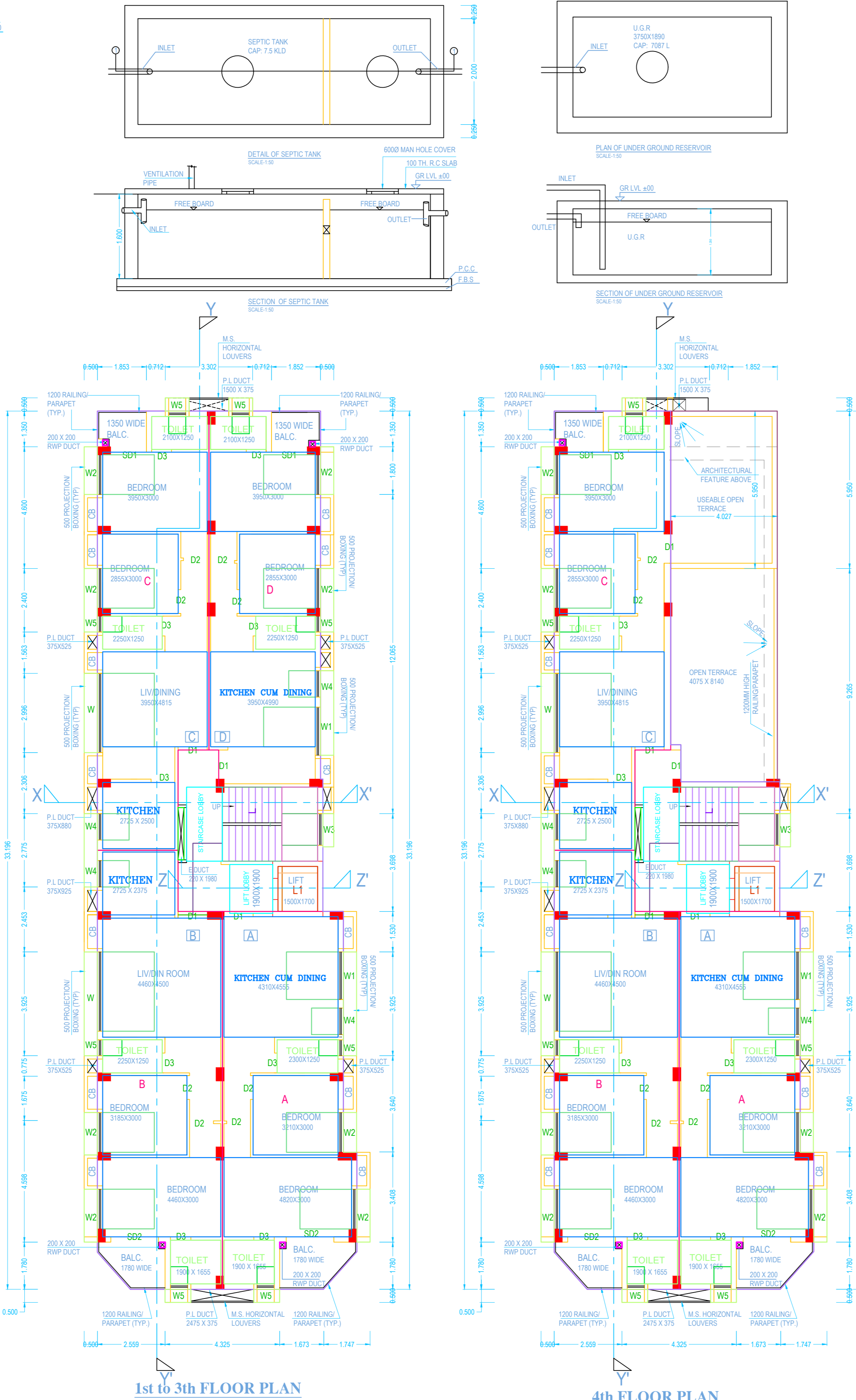
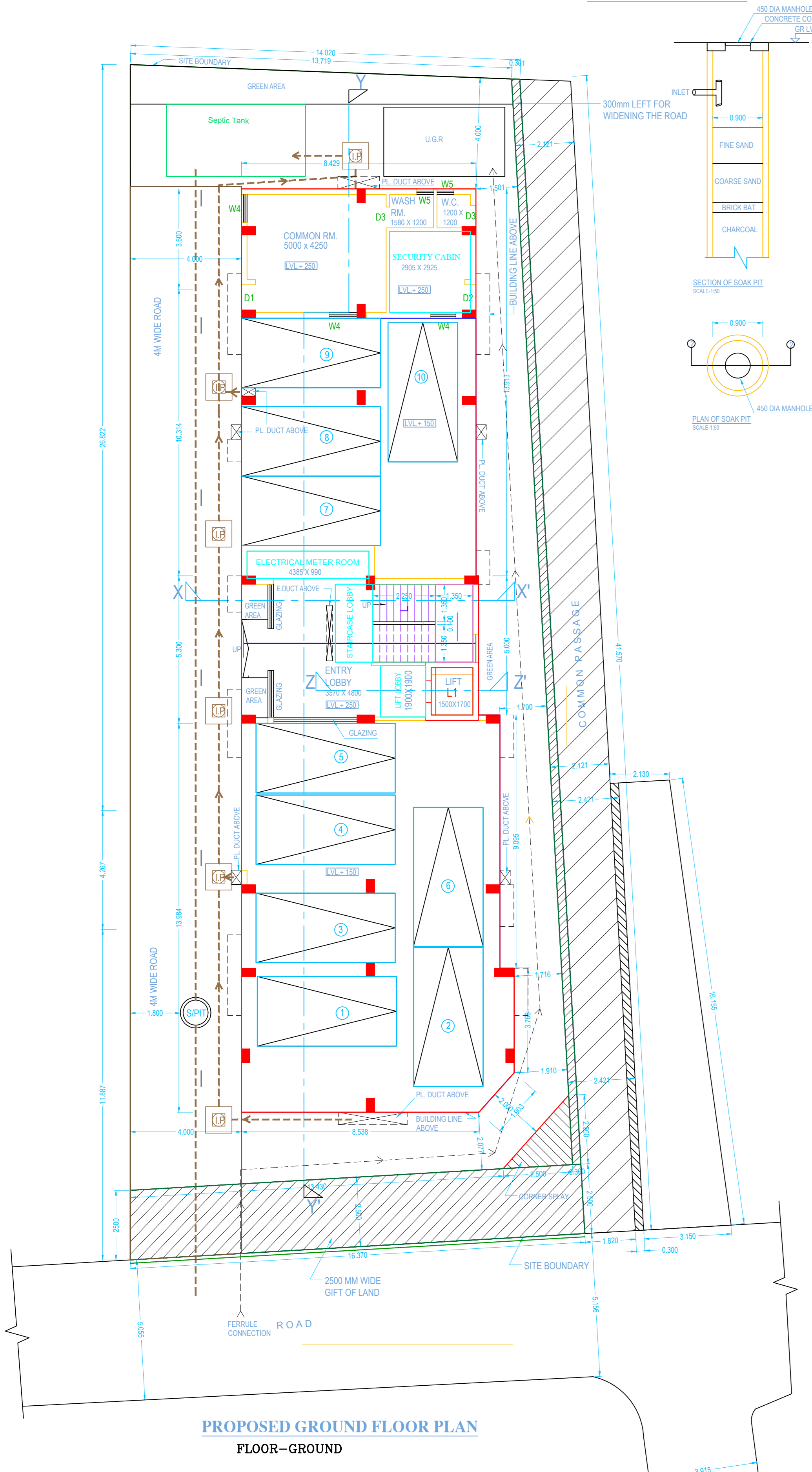
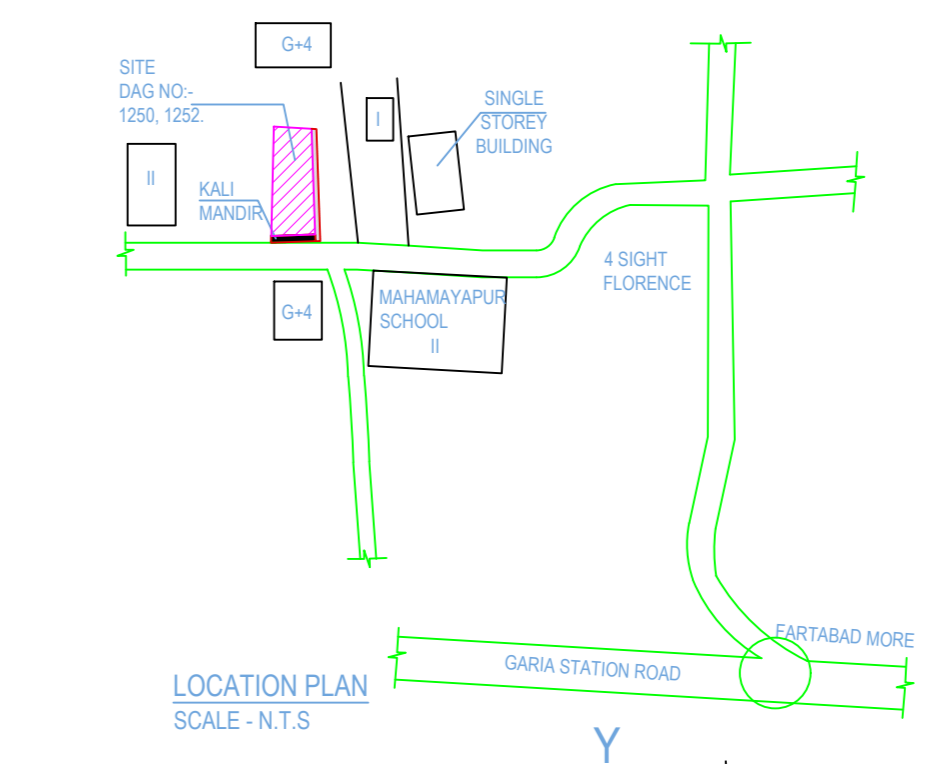

DOOR & WINDOW SCHEDULE

S.NO	MARK	WIDTH (MM)	HEIGHT (MM)	DOOR SIZE
1.	D1	1100	2100	1100X2100
2.	D2	900	2100	900X2100
3.	D3	750	2100	750X2100
4.	SD1	1350	2100	1350X2100
5.	SD2	1800	2100	1800X2100

S.NO	MK	WIDTH (MM)	HEIGHT (MM)	WINDOW SIZE
1.	W	3000	150	3000X150
2.	W1	1800	150	1800X150
3.	W3	1500	150	1500X150
4.	W3	1200	150	1200X150
5.	W4	1000	1100	1000X1100
6.	W5	600	1800	600X1800
7.	W6	1200	900	1200X900

PROPOSED G+V STORED RESIDENTIAL BUILDING AT HOLDING NO-24, MADHYA MAHAMAYA PUR, WARD NO-28, R.S. KHATIAN NO -348, 349. R. S. DAG NO - 1250,1252. J.L.NO. -47, MOUZA - BARHANS FARTABAD, UNDER RAJPUR SONARPUR MUNICIPALITY, P.S. - NARENDRAPUR, DIST - 24PGS.(S)

CERTIFIED WITH FULL RESPONSIBILITY THAT THE BUILDING PLAN HAS BEEN DRAWN UP AS PER PROVISION OF WEST BENGAL MUNICIPAL & BUILDING RULES, 2007, AS AMENDED FROM TIME TO TIME & THAT THE SITE CONDITION INCLUDING THE WIDTH OF THE ABUTTING ROAD/ COMMON PASSAGE CONFIRM WITH THE PLAN.

SUKANYA DASGUPTA
E.B.A. NO - 0692

THE STRUCTURAL DESIGN & DRAWING OF BOTH FOUNDATION AND SUPER STRUCTURE OF THE BUILDING HAS BEEN PREPARED BY ME CONSIDERING ALL POSSIBLE LOADS INCLUDING THE SEISMIC LOAD AS PER NATIONAL BUILDING CODE OF INDIA & THE FOUNDATION IS CAPABLE OF TAKING THE LOAD. CERTIFIED THAT IT IS SAFE AND STABLE IN ALL RESPECT.

BIBEK BIKASH MULLICK
ESE-021, CLASS- I
NAME OF THE STRUCTURAL ENGINEER

DETAILS OF POWER OF ATTORNEY
M/S GANGULY HOMERESEARCH PRIVATE LIMITED
REPRESENTED BY ITS DIRECTOR
SRI RUPESH RANJAN PRASAD
S.A. OF
1) SRI BIPUL KUMAR ROY
2) SRI MANAS KUMAR ROY
3) ARPITA ROY
4) ARUN BIHARI
5) SMT. RITA MITRA
6) SMT. URMILA MOJAK
NAME OF OWNER

